

01 2x6 Framed Wall to R.C. Foundation Connection Detail

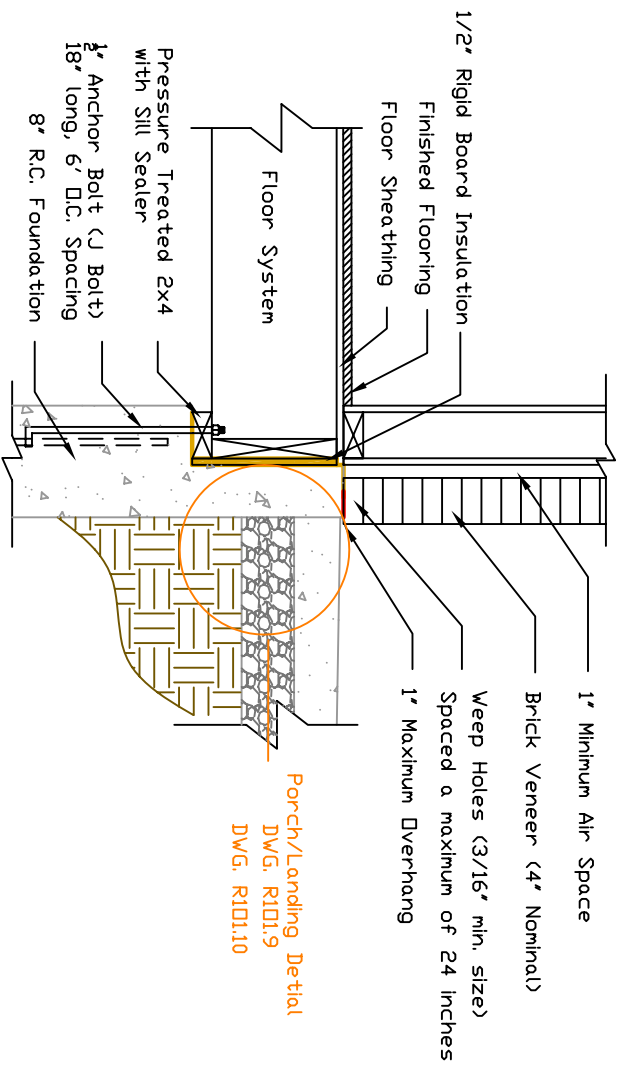

03 2x4 Brick Veneer Wall to R.C. Foundation Connection Detail

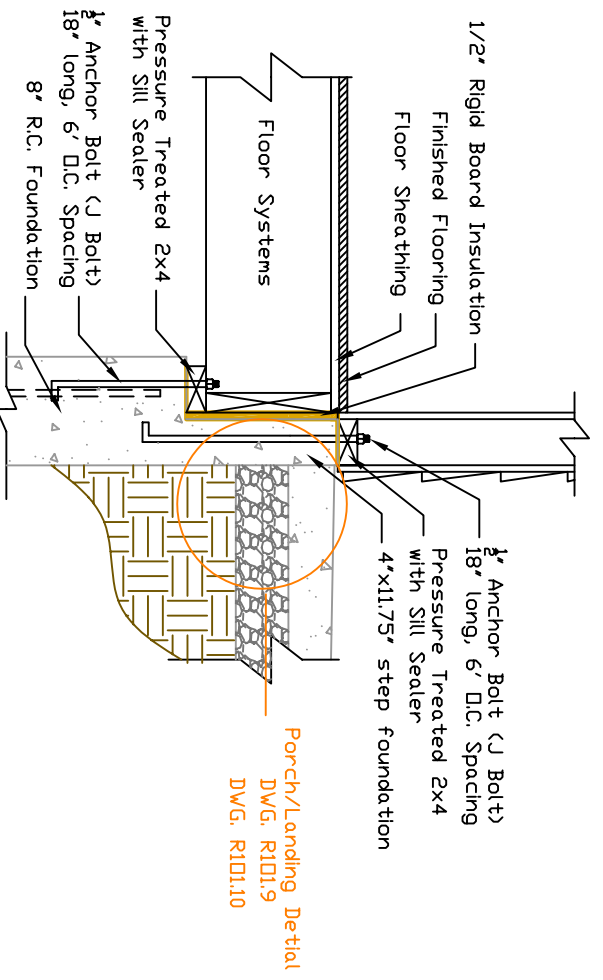

02 2x4 Framed Wall to R.C. Foundation Connection Detail

Revisions:

3/24/04
4/1/04
4/11/04
4/14/04
4/28/04

Notes:

1. All reinforcement bars as required by local building code (IRC 2003)
2. Strapping or approved fastening device can be used instead of anchor bolts.
3. Header location can be moved back from step foundation in accordance to local building code.



PHRC: _____
 HYD/LIFT: _____

R.C. Foundation Wall

Scale: 1" = 10'

Developed By: Fred W. Peters
 Drawn By: Fred W. Peters

R101.8-5/26/04